

NORTH YORKSHIRE LOCAL ACCESS FORUM

21st November 2012

A684 BEDALE, AISKEW AND LEEMING BAR BYPASS SIDE ROAD ORDERS

1.0 PURPOSE OF REPORT

- 1.1 The Highways & Transportation team within North Yorkshire County Council have requested that members are made aware of recently published side road orders.

2.0 BACKGROUND

- 2.1 The formal notice and side road orders are attached at Appendix 1.
- 2.2 The relevant plans are attached at Appendix 2 – please note that these have been reduced to A3 size for the purposes of distribution and so are no longer to scale. Accurate to scale versions are available at the meeting.

3.0 RECOMMENDATIONS

- 3.1 It is recommended that members receive the side road orders for information.

Contact Officer
Aidan Rayner
01609 533077

HIGHWAYS ACT 1980

NORTH YORKSHIRE COUNTY COUNCIL (A684 BEDALE, AISKEW AND LEEMING BAR BYPASS CLASSIFIED ROAD) (SIDE ROADS) ORDER 2012

RECEIVED BY
WACS ADMIN

23 OCT 2012

The North Yorkshire County Council hereby give notice that they have made, and submitted to the Secretary of State for Transport for confirmation, an Order under Section 14 and Section 125 of the Highways Act 1980 authorising the Council to: -

- (a) improve highways (including raising, lowering or otherwise altering);
- (b) stop up highways;
- (c) construct new highways;
- (d) stop up private means of access to premises; and
- (e) provide new means of access to said premises;

all on or in the vicinity of the route of the classified road known as the A684 Bedale, Aiskew and Leeming Bar Bypass, which the Council are proposing to construct between the A684, North End, Bedale and the A684, Northallerton Road, Leeming Bar.

Copies of the Order and the relevant plans may be inspected free of charge at all reasonable hours at North Yorkshire County Council, County Hall, Northallerton, DL7 8AD and at Bedale Library, Bedale Hall, Bedale, North Yorkshire DL8 1AA.

ANY PERSON may, not later than **Tuesday 11 December 2012**, object to the confirmation of the Order by notice to the Secretary of State for Transport at the offices of the National Transport Casework Team, 2nd Floor, Lancaster House, Hampshire Court, Newcastle Business Park, Newcastle upon Tyne NE4 7YH stating the name of the Order and the grounds of their objection in writing.

Dated: 18 October 2012

CAROLE DUNN
Assistant Chief Executive (Legal and Democratic Services)

County Hall
NORTHALLERTON

HIGHWAYS ACT 1980
THE NORTH YORKSHIRE COUNTY COUNCIL
(A684 BEDALE, AISKEW AND LEEMING BAR BYPASS CLASSIFIED ROAD)
(SIDE ROADS) ORDER 2012

The North Yorkshire County Council ('the Council') make this Order in exercise of their powers under Sections 14 and 125 of the Highways Act 1980 and all other powers enabling them in that behalf:

1. (1) The Council are authorised in relation to the Classified Road at the A684 North End to A684 Northallerton Road in the parishes of Bedale, Leeming Bar and Scruton in the county of North Yorkshire to:
 - (a) improve the lengths of highway named in the Schedule to this order and shown on the Site Plans by cross hatching;
 - (b) stop up each length of highway described in the Schedule and shown on the Site Plans by zebra hatching;
 - (c) construct a new highway along the route whose centre line is shown on the Site Plans by an unbroken black line surrounded by stipple;
 - (d) stop up each private means of access to premises described in the said Schedule and shown on the Site Plans by a solid black band; and
 - (e) provide new means of access to premises along the route at each location shown on the Site Plans by thin diagonal hatching.
 - (2) Where a new highway is to be constructed wholly or partly along the same route as a new access or part of one, that new highway shall be created subject to the private rights over that new access.
 - (3) Each new highway is given a reference letter on the Site Plan, which is also placed in the said Schedule, and will be a road unless the word "bridleway", "cycle track" or "footpath" appears beneath its reference letter in that Schedule, in which case it will be a bridleway, cycle track or footpath (as the case may be). Each new access is given a number on the Site Plan, which is also placed in the said Schedule.
 - (4) Where a new highway is to be constructed or a new access is to be provided in connection with the stopping up of a length of highway or private means of access described in the said Schedule, its reference letter or number (as the case may be) is placed in the said Schedule opposite the description of that length.
 - (5) Each Site Plan shows the works indicated in the said Schedule, and the route of the Classified Road in relation to those works.
2. Where immediately before a length of highway is stopped up in pursuance of this Order there is under, in, on, over, along or across that highway any apparatus of Statutory Undertakers or any telecommunications code system operator, then, subject to Section 21 of the Highways Act 1980, those undertakers, or that operator, as the case may be, shall have the same rights as respects that apparatus as they had immediately before the stopping up took place.
3. In this Order:
 - (a) distances are measured along the route of the relevant highway or private means of access to the premises, as the case may be;
 - (b) a reference to a Schedule or Site Plan number is a reference to the Schedule or Site Plan so numbered;

- (c) **“the Classified Road”** means the A684 Bedale, Aiskew and Leeming Bar Bypass highway which the Council propose to construct, from a point 129m north-west of the centre of the access to Bedale Golf Club on the A684 North End, Bedale to 285m south-west of the centre of the junction with Mill Lane on the A684 Northallerton Road, Scruton and which is a proposed highway, which is a classified road in accordance with Section 12 of the Highways Act 1980;
- “the Council”** means the North Yorkshire County Council;
- “improvement”** in relation to a highway includes raising, lowering or otherwise altering that highway, and “improved” shall be construed accordingly;
- “new access”** means a means of access to premises authorised by this Order to be provided;
- “new highway”** means a highway authorised by this Order to be constructed and “new highways” shall be construed accordingly;
- “Schedule”** means a Schedule to this order, and “Schedules” shall be construed accordingly;
- “the Site Plan”** means one of the site plans numbered 1 to 10 contained in the plan folio marked ‘The North Yorkshire County Council (A684 Bedale, Aiskew and Leeming Bar Bypass Classified Road) (Side Roads) Order 2012’ sealed with the Common Seal of the Council and deposited at the offices of the Council at County Hall, Northallerton, DL7 8AD and a duplicate set has been deposited in the offices of the Secretary of State for Transport.

SCHEDULE 1

SITE PLAN NO. 1 - A684 North End, Bedale

Highway to be Improved

A684 North End from a point 65m south-east of the centre of the access to Bedale Golf Club for a distance of 40m in a south-easterly direction.

A684 North End from a point 300m north-west of the centre of the access to Bedale Golf Club for a distance of 20m in a westerly direction.

Highway to be Stopped Up

A684 North End from a point 65m south-east of the centre of the access to Bedale Golf Club for a distance of 365m in a north-westerly direction.

Reference Letter(s) of New Highways

A & B

C
Bridleway

Private Means of Access to be Stopped Up

- a. Access to field (OS field number – 3876, OS Sheet SE2688) off the A684 North End 293m north-west of the centre of the access to Bedale Golf Club.
- b. Access to field (OS field number – 5563, OS Sheet SE2688) off the A684 North End 30m south-east of the centre of the access to Bedale Golf Club.
- c. Access to Bedale Golf Club.

Reference Number(s) of New Accesses

1 & 2

3

4

SCHEDULE 2

SITE PLAN NO. 2 - Sand Hill Farm, Aiskew

Private Means of Access to be Stopped Up

**Reference Number(s) of New
Accesses**

–

5, 6, 7 & 8

- d. Access track from Sand Hill Farm to Scurf Beck adjacent to Sand Hill Plantation for a distance of 92m.

9, 10 & 11

SCHEDULE 3

SITE PLAN NO. 3 - East of Sand Hill Plantation, Aiskew

Private Means of Access to be Stopped Up

**Reference Number(s) of New
Accesses**

—

12 & 13

SCHEDULE 4

SITE PLAN NO. 4 – East of A1(M) Leeming Bar Junction Leases Road Link Road

Highway to be Improved

Leases Link Road from the junction with the A1
Eastern roundabout to Leases Road Roundabout

Highway to be Stopped Up

-

Reference Letter(s) of New

Highways

D, E &F
All Bridleway

Private Means of Access to be Stopped Up

- m. Access to field off Leases Road link road,
situated 138m east from the eastern A1(M)
Leeming Bar Junction.

- n. Access to field off Leases Road link road,
situated 138m east from the eastern A1(M)
Leeming Bar Junction.

Reference Number(s) of New **Accesses**

16 (Site Plan No.5)

15 (Site Plan No.5, Inset 5B)

SCHEDULE 5

SITE PLAN NO. 5 - Leases Road, Leeming Bar

Highway to be Improved

Leases Road from a point 11m north-west of the centre of the junction with Conygarth Way to a point 19m south-east of the southern access to Fairfield Farm, a distance of 406m.

Highway to be Stopped Up

–

Reference Letter(s) of New Highways

K

F,I
Bridleway

Leases Road from a point 117m north-west of the centre of the junction with Conygarth Way north westwards for a distance of 5m.

G
Bridleway

Leases Road from a point 165m south-east of the centre line of the junction of the southern access to Fairfield Farm south eastwards for a distance of 5m.

E
Bridleway

Private Means of Access to be Stopped Up

–

Reference Number(s) of New Accesses

14

e. Access to field off Leases Road, situated 124m north-west of the junction with Conygarth Way.

15

f. Access to field off Leases Road, situated 85m south-east of the southern access to Fairfield Farm.

16

g. Access to field (OS field number – 3600, OS Sheet SE2890) off Leases Road, situated 30m south-east of the southern access to Fairfield Farm.

17

SCHEDULE 6

SITE PLAN NO. 6 - Low Street, Leeming Bar

Highway to be Improved

Low Street at a point 4m north of the centre of the access to 'Ashville' for a distance of 25m in a northerly direction.

Low Street at a point 155m north of the centre of the access to 'Ashville' for a distance of 62m in a northerly direction.

Highway to be Stopped Up

—

Low Street at a point 29m north of the centre of the access of 'Ashville' for a distance of 151m in a north-westerly direction.

Reference Letter(s) of New Highways

I
Bridleway

L, M & O
All Bridleway

K

Private Means of Access to be Stopped Up

Reference Number(s) of New Accesses

- h. Access to field (OS field number – 5900, OS Sheet SE2890) off Low Street, 152m north-west of the centre of the access to 'Ashville'.
- i. Access to field (OS field number – 9000, OS Sheet SE2890) off Low Street, 58m north of the centre of the access to 'Ashville'.
- j. Access track between Low Street and Hamhall Lane, at a point 900m south-westerly from its junction with Ham Hall Lane for a distance of 270m in a south-westerly direction (Site Plan No.7)

18

20

19 & 22 (Site Plan No.7)

SCHEDULE 7

SITE PLAN NO. 7 - Terry House Drain near Low Street, Leeming Bar

Private Means of Access to be Stopped Up

**Reference Number(s) of New
Accesses**

—

19 & 21

- j. Access track between Low Street and Hamhall Lane, at a point 900m south-westerly from its junction with Ham Hall Lane for a distance of 270m in a south-westerly direction.

19 & 22

SCHEDULE 8

SITE PLAN NO. 8 – Wensleydale Railway nr Northallerton Road, Scruton

Private Means of Access to be Stopped Up

**Reference Number(s) of New
Accesses**

–

19 & 23

–

19, 24 & 25

SCHEDULE 9

SITE PLAN NO. 9 – Wensleydale Railway near Ham Hall Lane, Scruton

Private Means of Access to be Stopped Up

**Reference Number(s) of New
Accesses**

—

25 & 26

SCHEDULE 10

SITE PLAN NO. 10 – A684 Northallerton Road, near Spring House, Scruton

Highway to be Improved

A684 Northallerton Road at a point 15m east of the centre of the eastern access to Holmfield Farm for a distance of 56m in an westerly direction.

A684 Northallerton Road at a point 22m south-west of the centre of the junction with Mill Lane for a distance of 35m in a north-easterly direction.

Highway to be Stopped Up

A684 Northallerton Road at a point 15m east of the centre of the eastern access to Holmfield Farm for a distance of 442m in a north-easterly direction.

Reference Letter(s) of New Highways

T & V

S & U
All Bridleway

Private Means of Access to be Stopped Up

—

Reference Number(s) of New Accesses

27 & 28

k. Access to Broadacres, Scruton

29

Given under the Common Seal of the North Yorkshire County Council, the 17th
Day of October 2012.

The COMMON SEAL of NORTH YORKSHIRE COUNTY COUNCIL was hereunto affixed in
the presence of:

Jawai

A duly authorised signatory



This plan is not sealed and is not to scale

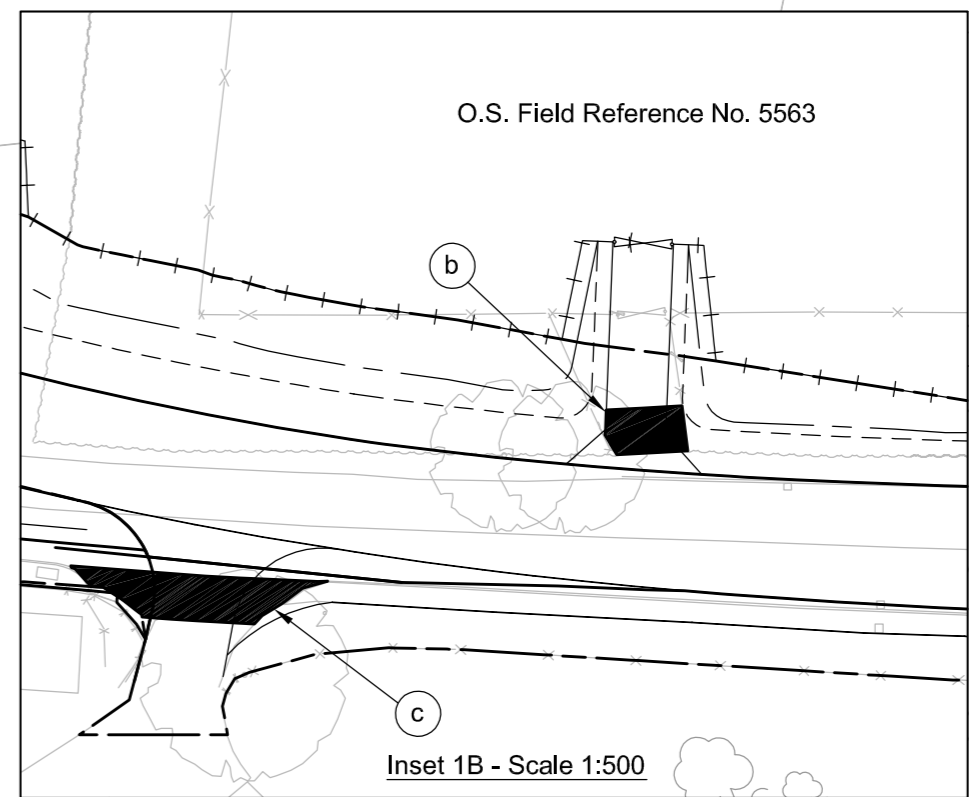
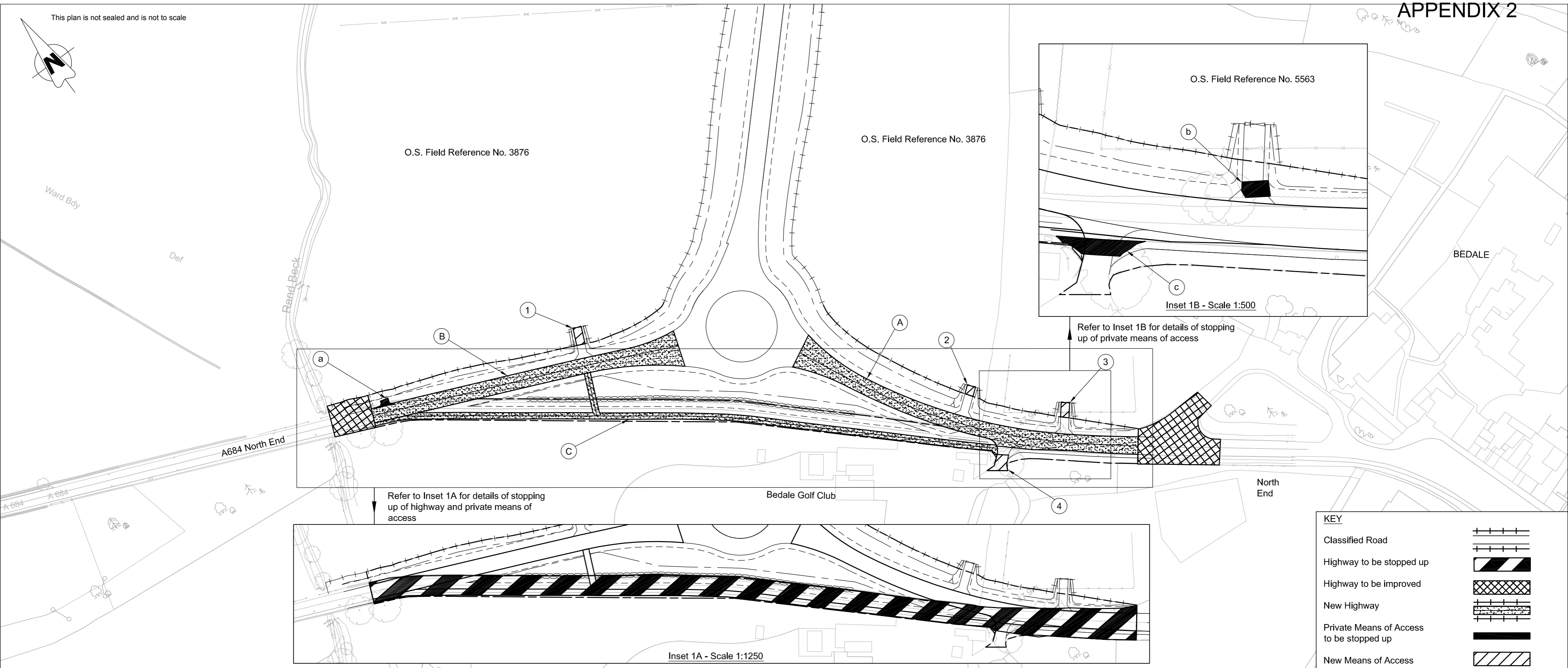
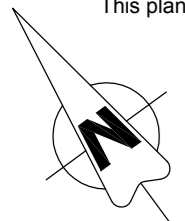

Refer to Inset 1B for details of stopping up of private means of access

Refer to Inset 1A for details of stopping up of highway and private means of access

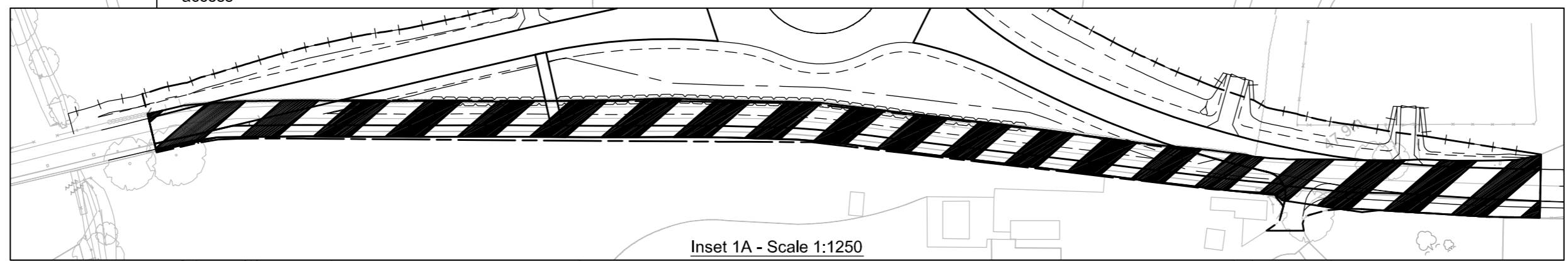

KEY	
Classified Road	
Highway to be stopped up	
Highway to be improved	
New Highway	
Private Means of Access to be stopped up	
New Means of Access	

The COMMON SEAL of NORTH YORKSHIRE COUNTY COUNCIL
 was hereunto affixed this day of 2012
 In the presence of:

 a duly authorised signatory

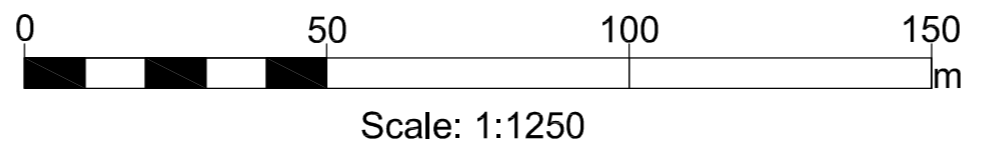
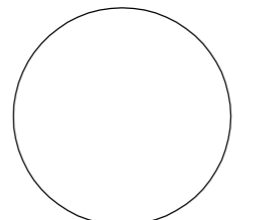

This map is reproduced from Ordnance Survey material with the permission of Ordnance Survey on behalf of the Controller of Her Majesty's Stationery Office © Crown copyright. Unauthorised reproduction infringes Crown copyright and may lead to prosecution or civil proceedings. North Yorkshire County Council 100017946 (2012). EXTRACT FROM ORDNANCE SURVEY SHEETS SE2588, SE2688

MAP REFERRED TO IN THE NORTH YORKSHIRE COUNTY COUNCIL (A684 BEDALE, AISKEW AND LEEMING BAR BYPASS CLASSIFIED ROAD) (SIDE ROADS) ORDER 2012
SITE PLAN No. 1
 A684 North End, Bedale

This plan is not sealed and is not to scale

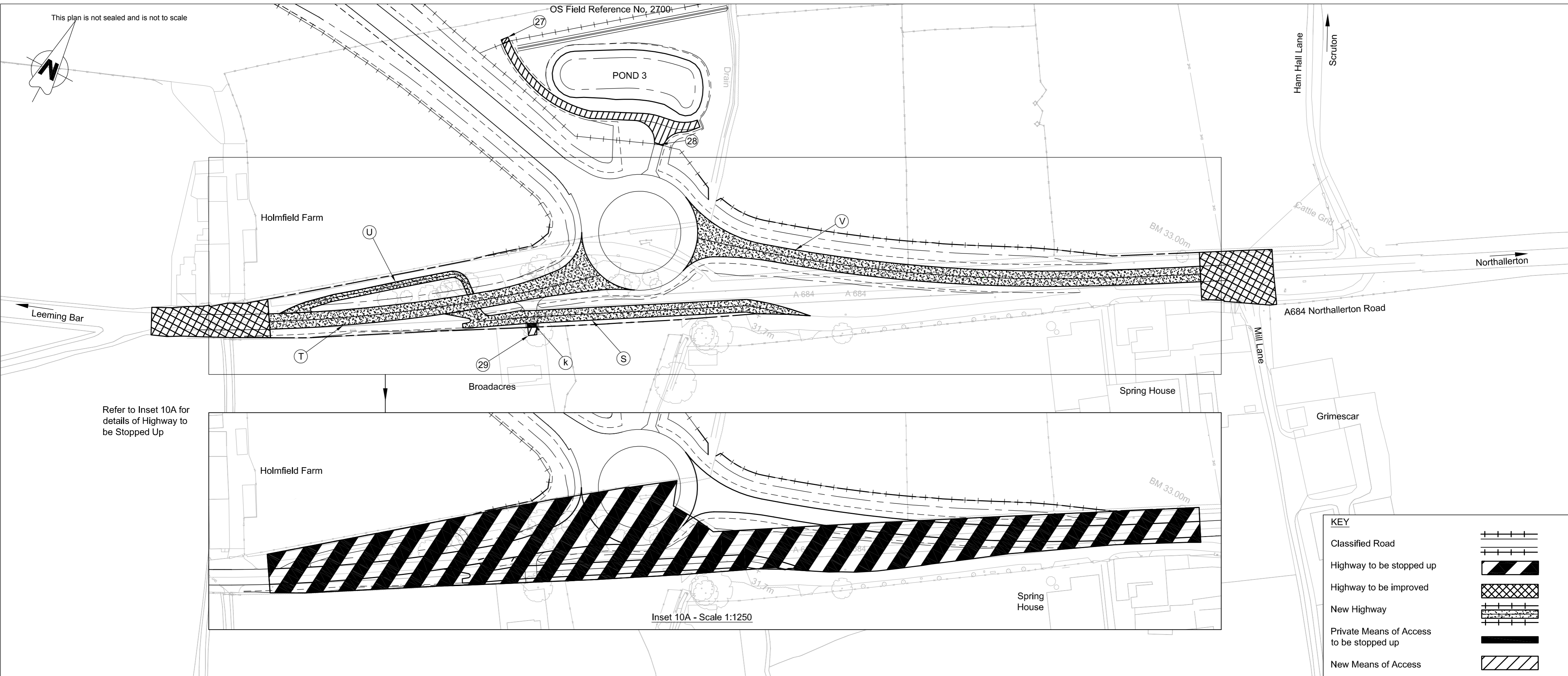

Refer to Inset 10A for details of Highway to be Stopped Up

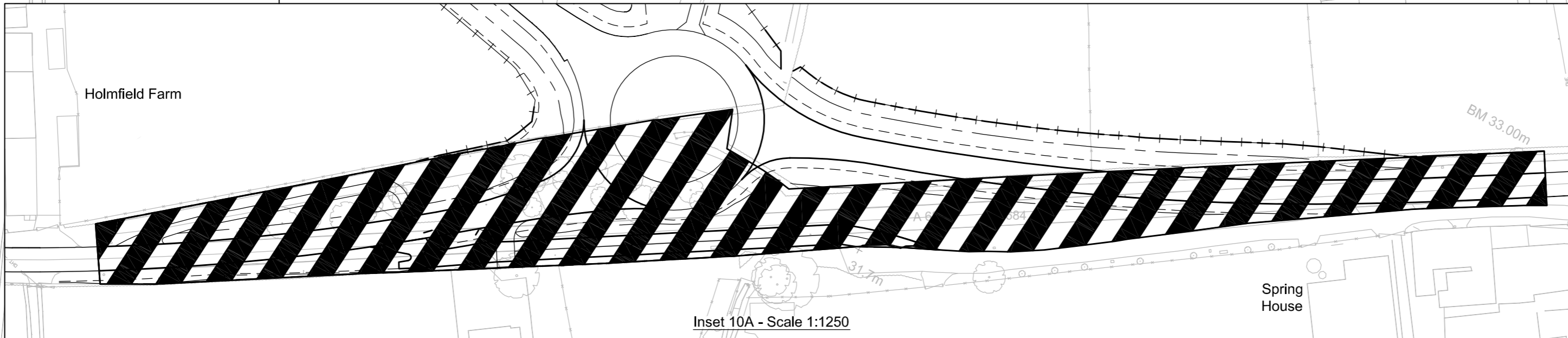

KEY	
Classified Road	
Highway to be stopped up	
Highway to be improved	
New Highway	
Private Means of Access to be stopped up	
New Means of Access	

The COMMON SEAL of NORTH YORKSHIRE COUNTY COUNCIL
 was hereunto affixed this day of 2012
 In the presence of:

 a duly authorised signatory

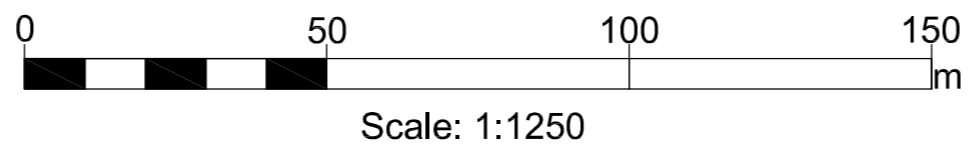
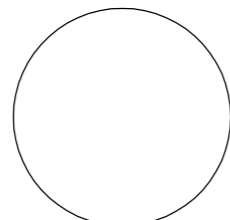

This map is reproduced from Ordnance Survey material with the permission of Ordnance Survey on behalf of the Controller of Her Majesty's Stationery Office © Crown copyright. Unauthorised reproduction infringes Crown copyright and may lead to prosecution or civil proceedings.
 North Yorkshire County Council 100017946 (2012).
 EXTRACT FROM OS SHEETS
 SE2990, SE3090, SE3091

MAP REFERRED TO IN THE NORTH YORKSHIRE COUNTY COUNCIL (A684 BEDALE, AISKEW AND LEEMING BAR BYPASS CLASSIFIED ROAD) (SIDE ROADS) ORDER 2012
SITE PLAN No. 10
 A684 Northallerton Road, Spring House, Scruton

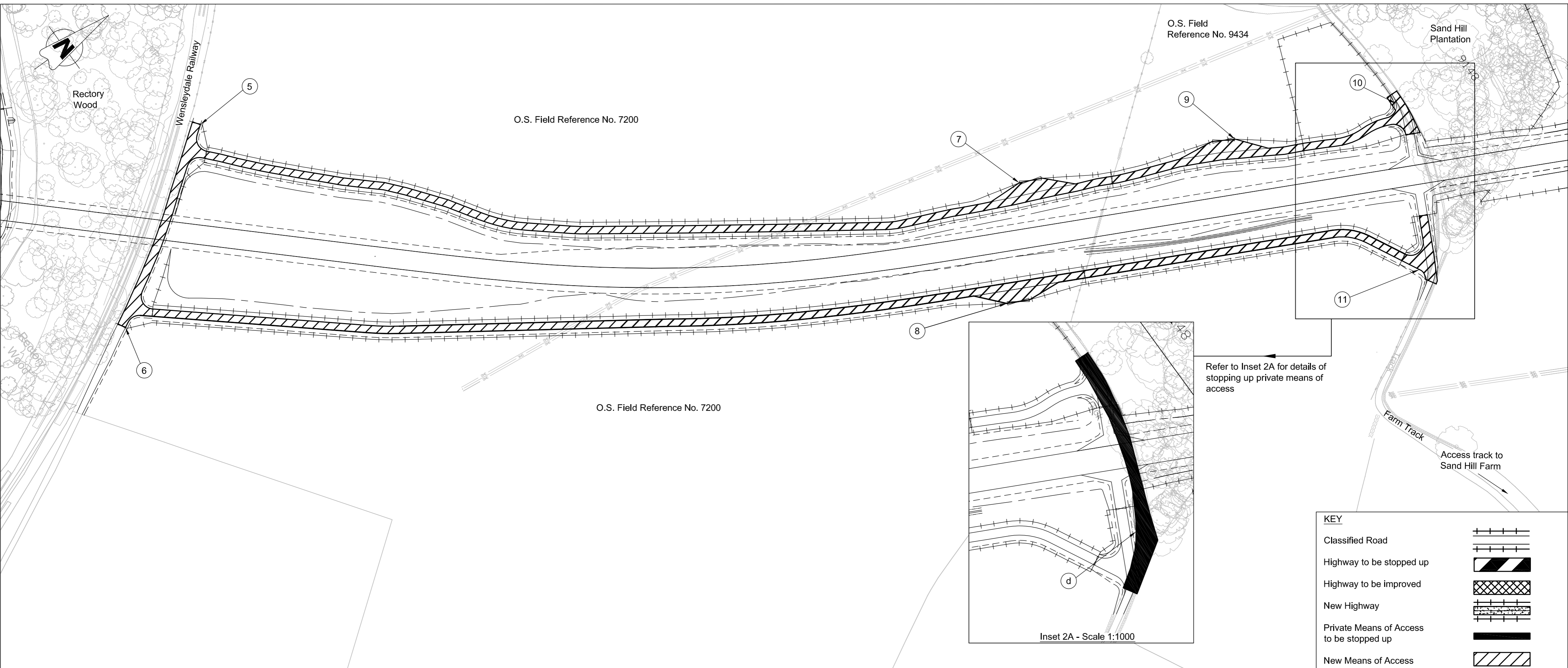

KEY	
Classified Road	
Highway to be stopped up	
Highway to be improved	
New Highway	
Private Means of Access to be stopped up	
New Means of Access	

The COMMON SEAL of NORTH YORKSHIRE COUNTY COUNCIL
 was hereunto affixed this day of 2012
 In the presence of:

 a duly authorised signatory

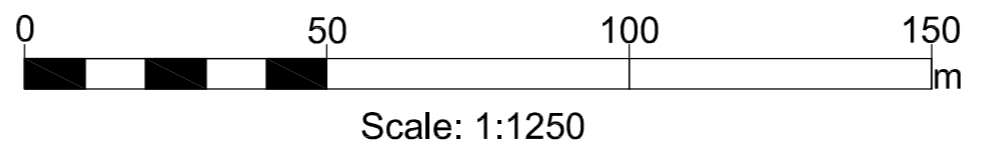
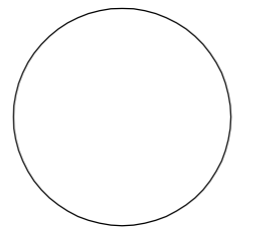

This map is reproduced from Ordnance Survey material with the permission of Ordnance Survey on behalf of the Controller of Her Majesty's Stationery Office © Crown copyright. Unauthorised reproduction infringes Crown copyright and may lead to prosecution or civil proceedings.
 North Yorkshire County Council 100017946 (2012).
 EXTRACT FROM OS SHEETS
 SE2688, SE2689, SE2789

MAP REFERRED TO IN THE NORTH YORKSHIRE COUNTY COUNCIL (A684 BEDALE, AISKEW AND LEEMING BAR BYPASS CLASSIFIED ROAD) (SIDE ROADS) ORDER 2012
SITE PLAN No. 2
 Sand Hill Farm, Aiskew

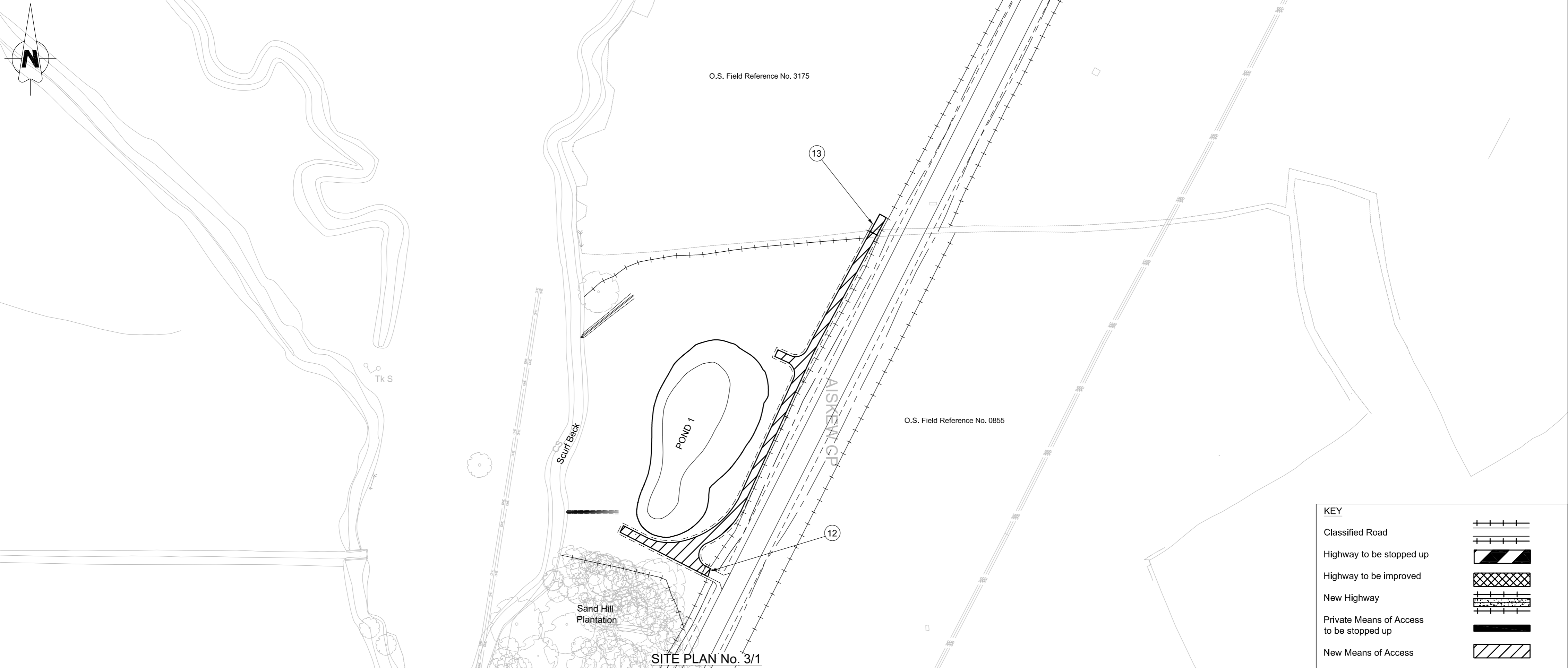

KEY	
Classified Road	
Highway to be stopped up	
Highway to be improved	
New Highway	
Private Means of Access to be stopped up	
New Means of Access	

SITE PLAN No. 3/1

The COMMON SEAL of NORTH YORKSHIRE COUNTY COUNCIL
 was hereunto affixed this day of 2012
 In the presence of:

 a duly authorised signatory

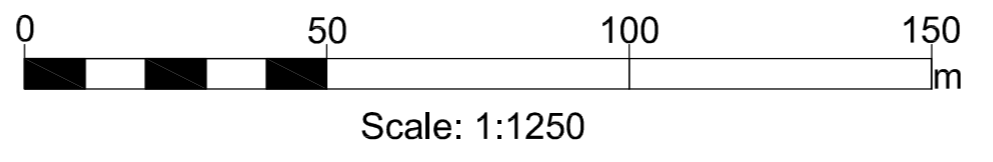
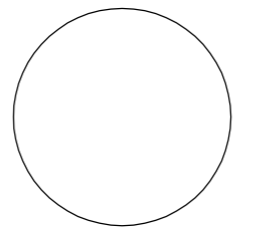

This map is reproduced from Ordnance Survey material with the permission of Ordnance Survey on behalf of the Controller of Her Majesty's Stationery Office © Crown copyright. Unauthorised reproduction infringes Crown copyright and may lead to prosecution or civil proceedings.
 North Yorkshire County Council 100017946 (2012).
 EXTRACT FROM OS SHEETS
 SE2689, SE2789 (3/1)
 SE2790, SE2890 (3/2)

MAP REFERRED TO IN THE NORTH YORKSHIRE COUNTY COUNCIL (A684 BEDALE, AISKEW AND LEEMING BAR BYPASS CLASSIFIED ROAD) (SIDE ROADS) ORDER 2012
SITE PLAN No. 3
 East of Sand Hill Plantation, Aiskew

This plan is not sealed and is not to scale

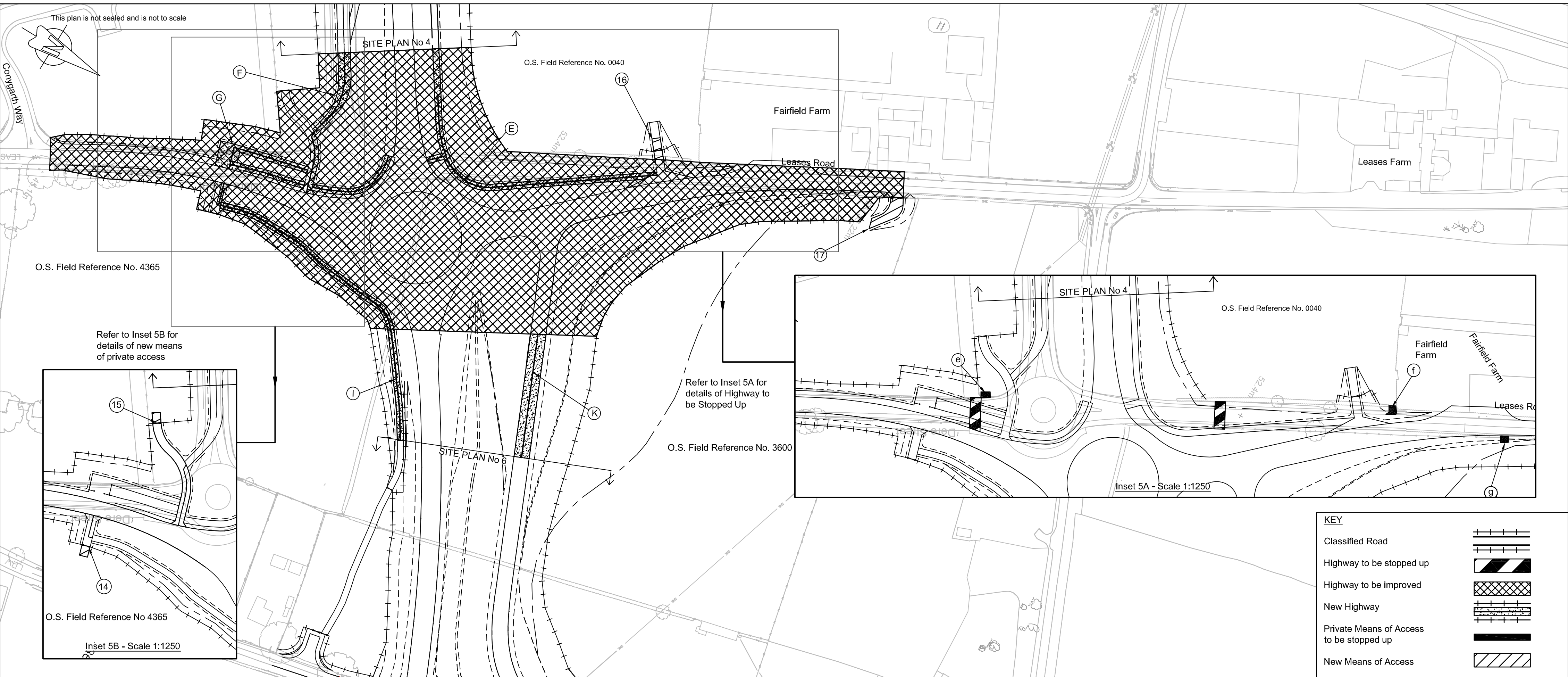

Refer to Inset 5B for details of new means of private access

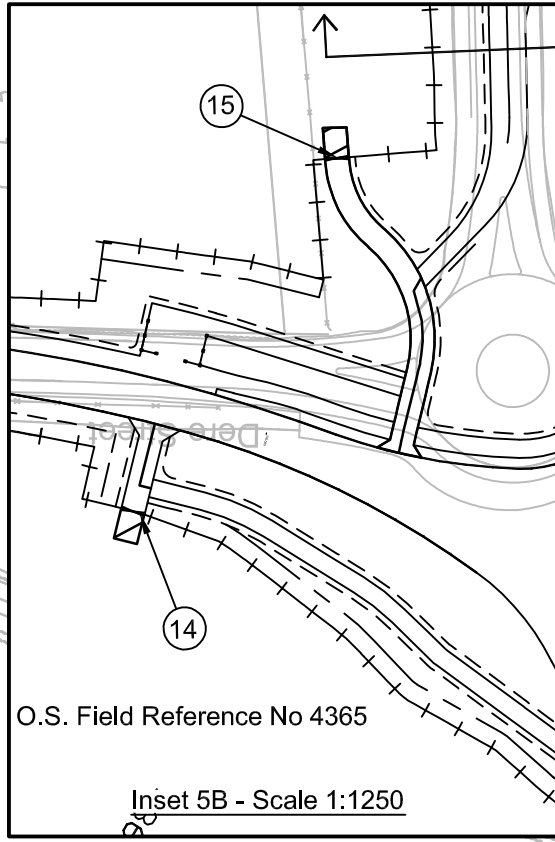

Refer to Inset 5A for details of Highway to be Stopped Up

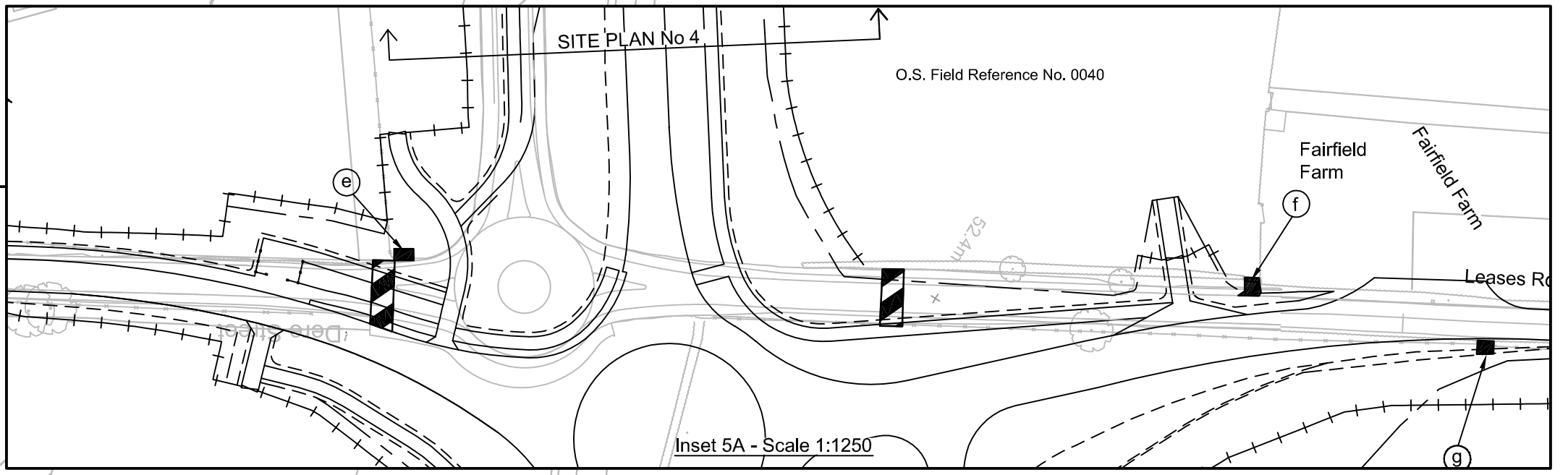

KEY	
Classified Road	
Highway to be stopped up	
Highway to be improved	
New Highway	
Private Means of Access to be stopped up	
New Means of Access	

The COMMON SEAL of NORTH YORKSHIRE COUNTY COUNCIL
 was hereunto affixed this day of 2012
 In the presence of:

 a duly authorised signatory

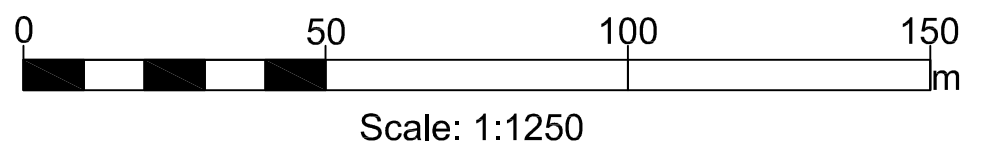
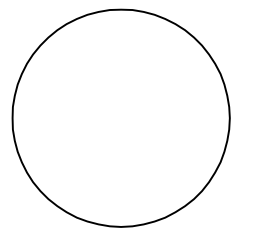

This map is reproduced from Ordnance Survey material with the permission of Ordnance Survey on behalf of the Controller of Her Majesty's Stationery Office © Crown copyright. Unauthorised reproduction infringes Crown copyright and may lead to prosecution or civil proceedings.
 North Yorkshire County Council 100017946 (2012).
 EXTRACT FROM OS SHEETS
 SE2890, SE2891

MAP REFERRED TO IN THE NORTH YORKSHIRE COUNTY COUNCIL (A684 BEDALE, AISKEW AND LEEMING BAR BYPASS CLASSIFIED ROAD) (SIDE ROADS) ORDER 2012
SITE PLAN No. 5
 Leases Road, Leeming Bar

This plan is not sealed and is not to scale

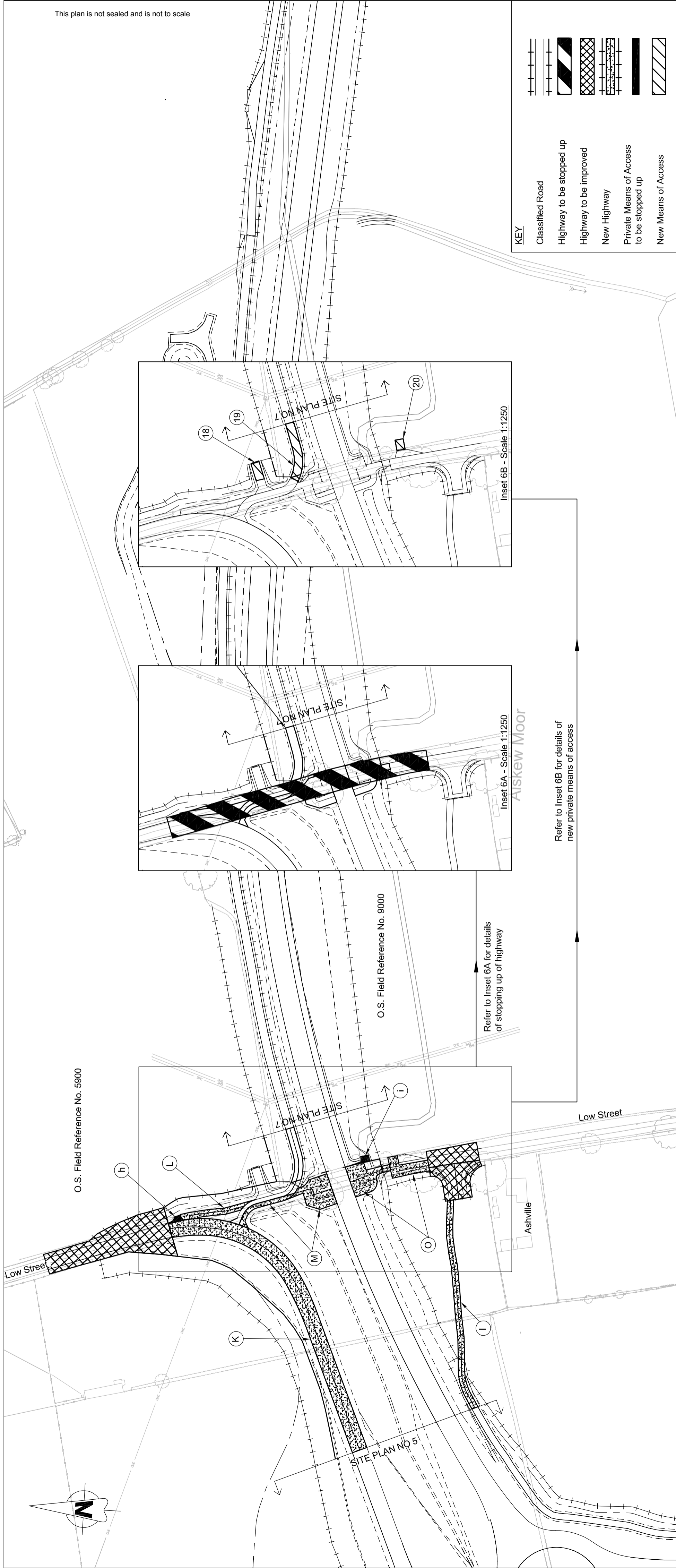

KEY	
	Classified Road
	Highway to be stopped up
	Highway to be improved
	New Highway
	Private Means of Access to be stopped up
	New Means of Access

MAP REFERRED TO IN THE NORTH YORKSHIRE COUNTY COUNCIL (A684 BEDALE, AISKEW AND LEEMING BAR BYPASS CLASSIFIED ROAD) (SIDE ROADS) ORDER 2012
SITE PLAN No. 6
 Low Street, Leeming Bar

This map is reproduced from Ordnance Survey material with the permission of Ordnance Survey on behalf of the Controller of Her Majesty's Stationery Office © Crown copyright. Unauthorised reproduction infringes Crown copyright and may lead to prosecution or civil proceedings.
 North Yorkshire County Council 100017946 (2012).
 EXTRACT FROM OS SHEETS
 SE2890, SE2891, SE2900, SE2991

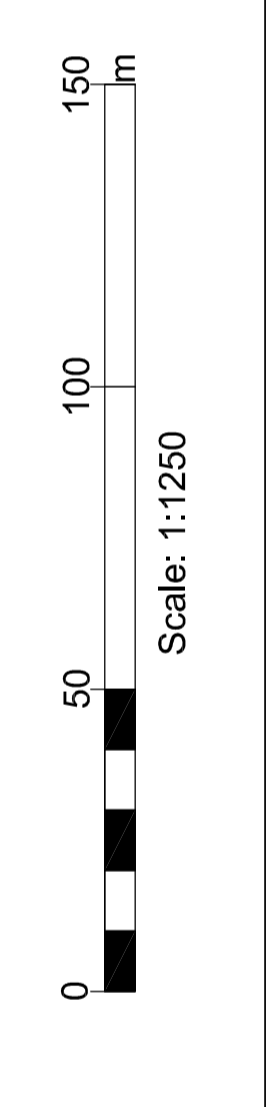

The COMMON SEAL of NORTH YORKSHIRE COUNTY COUNCIL
 was hereunto affixed this 2012
 day of
 In the presence of:

 a duly authorised signatory

This plan is not sealed and is not to scale

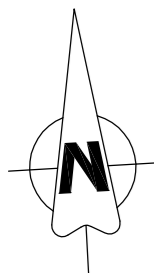

OS Field Reference No. 0006

OS Field Reference No. 5900

SWALE ED

Terry House Drain

Low Street

19

21

22

POND 2

SITE PLAN NO 8

SITE PLAN NO 5

j

OS Field Reference No. 9000

KEY	
Classified Road	
Highway to be stopped up	
Highway to be improved	
New Highway	
Private Means of Access to be stopped up	
New Means of Access	

The COMMON SEAL of NORTH YORKSHIRE COUNTY COUNCIL was hereunto affixed this _____ day of _____ 2012

In the presence of: a duly authorised signatory

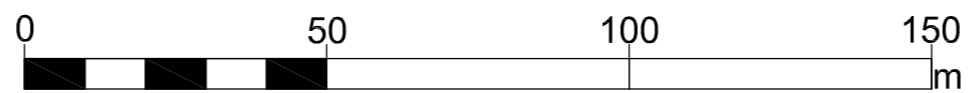
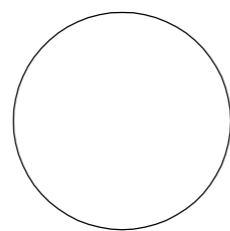

Scale: 1:1250

This map is reproduced from Ordnance Survey material with the permission of Ordnance Survey on behalf of the Controller of Her Majesty's Stationery Office © Crown copyright. Unauthorised reproduction infringes Crown copyright and may lead to prosecution or civil proceedings. North Yorkshire County Council 100017946 (2012). EXTRACT FROM OS SHEETS SE2890, SE2891, SE2990, SE2991

MAP REFERRED TO IN THE NORTH YORKSHIRE COUNTY COUNCIL (A684 BEDALE, AISKEW AND LEEMING BAR BYPASS CLASSIFIED ROAD) (SIDE ROADS) ORDER 2012 **SITE PLAN No. 7** Terry House Drain, near Low Street, Leeming Bar

This plan is not sealed and is not to scale

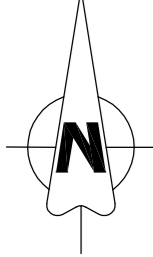

Def

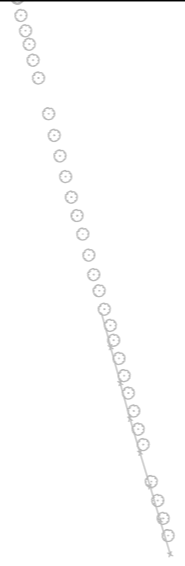

19
Track
Track

OS Field Reference No. 5700

MP 5

Wensleydale Railway

SITE PLAN NO 7

SITE PLAN NO 9

23

25

24

OS Field Reference No. 3200

OS Field Reference No. 3200

KEY

Classified Road	
Highway to be stopped up	
Highway to be improved	
New Highway	
Private Means of Access to be stopped up	
New Means of Access	

The COMMON SEAL of NORTH YORKSHIRE COUNTY COUNCIL
 was hereunto affixed this day of 2012
 In the presence of:

 a duly authorised signatory

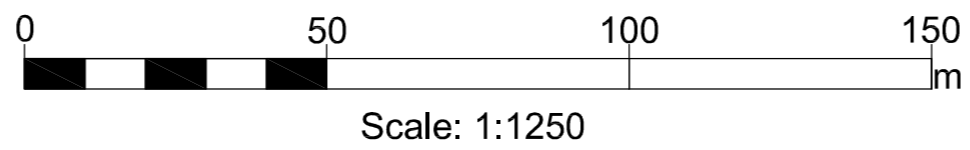
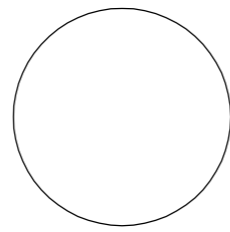

This map is reproduced from Ordnance Survey material with the permission of Ordnance Survey on behalf of the Controller of Her Majesty's Stationery Office © Crown copyright. Unauthorised reproduction infringes Crown copyright and may lead to prosecution or civil proceedings.
 North Yorkshire County Council 100017946 (2012).
 EXTRACT FROM OS SHEETS
 SE2890, SE2990, SE2991

MAP REFERRED TO IN THE NORTH YORKSHIRE COUNTY COUNCIL (A684 BEDALE, AISKEW AND LEEMING BAR BYPASS CLASSIFIED ROAD) (SIDE ROADS) ORDER 2012
SITE PLAN No. 8
 Wensleydale Railway, near Northallerton Road, Scruton

This plan is not sealed and is not to scale

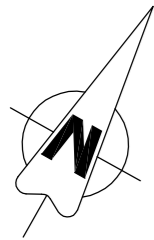

OS Field Reference No. 5700

26

25

SITE PLAN NO 8

Wensleydale Railway

OS Field Reference No. 2700

Scruton
Ham Hall Lane

Hamhall Lane

KEY	
Classified Road	
Highway to be stopped up	
Highway to be improved	
New Highway	
Private Means of Access to be stopped up	
New Means of Access	

The COMMON SEAL of NORTH YORKSHIRE COUNTY COUNCIL
 was hereunto affixed this day of 2012
 In the presence of:

 a duly authorised signatory

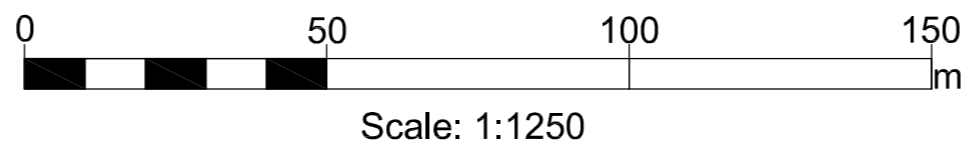
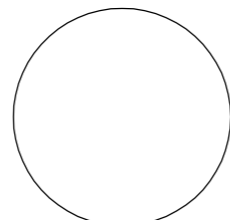

This map is reproduced from Ordnance Survey material with the permission of Ordnance Survey on behalf of the Controller of Her Majesty's Stationery Office © Crown copyright. Unauthorised reproduction infringes Crown copyright and may lead to prosecution or civil proceedings.
 North Yorkshire County Council 100017946 (2012).
 EXTRACT FROM OS SHEETS
 SE2990, SE2991, SE3091

MAP REFERRED TO IN THE NORTH YORKSHIRE COUNTY COUNCIL (A684 BEDALE, AISKEW AND LEEMING BAR BYPASS CLASSIFIED ROAD) (SIDE ROADS) ORDER 2012
SITE PLAN No. 9
 Wensleydale Railway, near Ham Hall Lane, Scruton

This plan is not sealed and is not to scale



PLAN FOLIO CONTENTS

SITE PLAN No 1	- A684 North End, Bedale
SITE PLAN No 2	- Sand Hill Farm, Aiskew
SITE PLAN No 3	- East of Sand Hill Farm Plantation, Aiskew
SITE PLAN No 4	- East of A1(M) Leeming Bar Junction Leases Road Link
SITE PLAN No 5	- Leases Road, Leeming Bar
SITE PLAN No 6	- Low Street, Leeming Bar
SITE PLAN No 7	- Terry House Drain, nr Low Street, Leeming Bar
SITE PLAN No 8	- Wensleydale Railway, nr Northallerton Road, Scruton
SITE PLAN No 9	- Wensleydale Railway, nr Hamhall Lane, Scruton
SITE PLAN No 10	- A684 Northallerton Road, nr Spring House, Leeming Bar

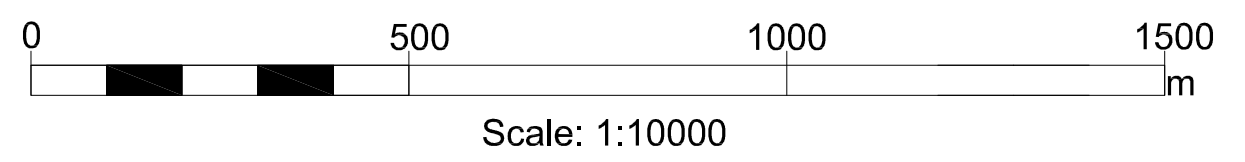

This map is reproduced from Ordnance Survey material with the permission of Ordnance Survey on behalf of the Controller of Her Majesty's Stationery Office © Crown copyright. Unauthorised reproduction infringes Crown copyright and may lead to prosecution or civil proceedings. North Yorkshire County Council 100017946 (2012).
 EXTRACT FROM OS SHEETS
 SE2588, SE2589, SE2590, SE2688, SE2689, SE2690
 SE2788, SE2789, SE2790, SE2791, SE2888, SE2889, SE2890, SE2891,
 SE2989, SE2990, SE2991, SE3089, SE3090, SE3091, SE3189, SE3190

MAP REFERRED TO IN THE NORTH YORKSHIRE COUNTY COUNCIL (A684 BEDALE, AISKEW AND LEEMING BAR BYPASS) (SIDE ROADS) ORDER 2012
LOCATION PLAN

**THE NORTH YORKSHIRE COUNTY COUNCIL
(A684 BEDALE, AISKEW AND LEEMING BAR BYPASS
CLASSIFIED ROAD) (SIDE ROADS) ORDER 2012**